

ANSI/SPRI/FM4435/ES-1 TEST PRESSURES UP TO 210 PSF (HORIZONTAL)

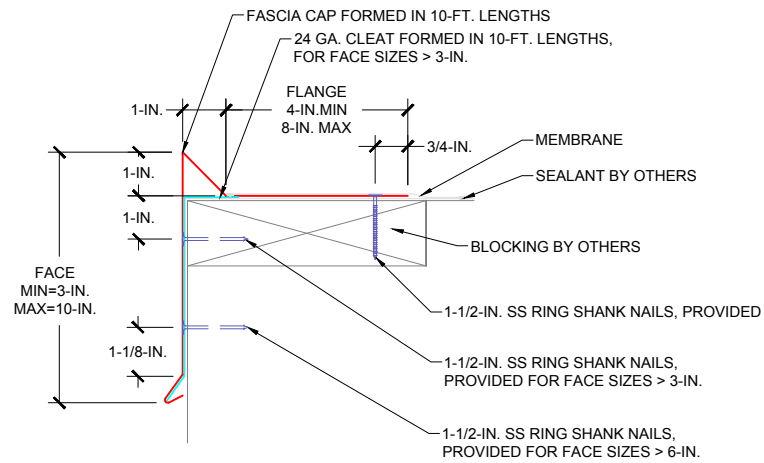

FOR MASONRY APPLICATIONS, PLEASE CONTACT OMG.

CONTACT OMG FOR APPROPRIATE RECOMMENDATIONS NEEDED TO MEET/EXCEED ANSI/SPRI/FM4435/ES-1 DESIGN CRITERIA

**APPLICATIONS**  
SINGLE-PLY MEMBRANES

**SIZES:**  
SEE DRAWING

**NOTES:**  
1—REFER TO ROOF MEMBRANE MANUFACTURER FOR THEIR APPROVED INSTALLATION DETAIL.  
2—TESTED IN ACCORDANCE WITH ANSI/SPRI/FM4435/ES-1.

ANSI/SPRI/FM4435/ES-1 TESTED

		4 Commerce Way Arden, NC 28704 828-675-1700 hickmanedgesystems.com	
		<b>ROOFER'S EDGE GRAVEL STOP</b>	
DRAWN BY: PL DATE: 03/20/2020	DESIGNED BY: KP DATE: 03/20/2020	SCALE: NOT TO SCALE	SHEET: 1 OF 1